

## Technical manual 2K pre-fill HS Topcoat



The ColorMatic pre-fill spray paint is pre-filled with propellant and specific additives and then filled by VitoMat filling machines with the desired coat. Innovative spray and valve technology guarantee the fine broad jet atomisation, a high application rate and constant pressure for best workmanship and professional-quality end results. 2K HS topcoat pre-fill offers the highest quality in terms of gloss, drying, and weather and petrol resistance.

### Quality and properties

- A spray can prepared with proellant gas, solvents and hardener (isocyanate containing) in a separate pre-filled cartridge. The 2K HS Topcoat is inserted in the can by a filling device and thus ready for the finished product
- The mixing of the 2K topcoat with the hardener achieves an optimal quality with respect to gloss, curing, weather and chemical resistance
- Simple, time-saving application
- Excellent atomisation
- Light blending

Ideal for spot repairs

### Physical and chemical data

- **Basis of binder:** Acryl
- **Colour:** depending on filling
- **Smell:** solvent
- **Efficiency:**  
Depending on consistence and colour of the ground:  
400 ml are sufficient for approx. 0,8 m<sup>2</sup>
- **Substrate:**  
according to colour of the ground 1K Primer Filler HG1 - HG8, ColorMatic 2K Hi-Speed Primer Filler no. 195 327, ColorMatic 1K Primer for ALU no. 190 278, ColorMatic 1K Primer for Zinc no. 190 285, ColorMatic 1K Epoxy Primer no. 174 414, ColorMatic 1K Filler, beige no. 856 556, ColorMatic 1K Filler, grey no. 874 987, cured paints sanded
- **Drying time (at 20°C, 50% relative air humidity):**  
The drying time depends on surrounding temperature, air humidity and thickness of the applied coat and filled type of paint (refer to information of the paint manufacturer)
- **Storage stability:** empty cans 36 month  
Pot life filled cans approx. 12 h (=10°-25°C, relative air humidity of max. 60%)
- **Size:**  
Aerosol cans, maximum nominal volume 400 ml, filling amount 100ml for TC-1 230677, TC-2 249457, TC-4 249471 and 80ml for TC-5 249464.

### Environment and labelling

**Environmentally compatible:** MOTIP DUPLI is committed to apply formulations without restricted or critical ingredients and to achieve best possible performance. The caps and packagings are made of recyclable material.

**Disposal:** Please mind the residue inside the containers. Completely emptied containers can be used for recycling. If cans are not emptied, they should be disposed off as "special refuse".

**Labelling:** All products of MOTIP DUPLI comply with the current status of their labelling regulations. Classification and distinction takes place by the presently legal form of the **Globally Harmonized System of Classification and Labelling of Chemicals** (GHS) or rather by CLP 1272/2008/EG regulations. Our safety data sheets comply with the current form of REACH 1907/2006/EG, article 31 und appendix II,

### Using instructions

**Before use, carefully read and observe the warning texts on the label!**

- Clean the surface to be painted thoroughly with ColorMatic silicone cleaner no. 174469, then sand
- Larger bare surfaces must be pre-primed with the appropriate ColorMatic primer
- The area must be dry and free of dust and grease
- Shake can vigorously for 2 minutes

**Mixing A components with hardener:**

- Remove protection cap from the bottom of the can and pull the pin out fully with the help of the inserted ring. This will release the knife, which will penetrate the wall of the aluminium cartridge.
- The cartridge will then rotate 360 °, be completely open and release the hardener.
- Shake the can vigorously to mix the A components with the hardener in the proper, predetermined ratio.
- Shake can vigorously for 2 minutes
- Carry out spray test
- Shake can vigorously for 2 minutes
- Carry out spray test
- Pot life: 24 hours (20 ° C)

Ready-to-use coating materials containing isocyanates can exert an irritant to the respiratory system and cause allergic

reactions. Inhalation of vapours and spray mist is a risk of sensitization. When dealing with substances containing isocyanates all measures for solvent-based coatings are considered. In particular, spray mist and vapours are not inhaled. Allergy and asthma sufferers and people who are prone to respiratory diseases should not perform work with isocyanates materials.

### Tips for spray painting

Protect the object and the surrounding area from spray mist. When painting small areas it is recommended that a piece of card is used as a mask, with a hole cut in it slightly larger than the area to be sprayed. The mask should be held 1 to 2 cm from the surface. With this method, the mainly part of the spray mist is brought under control. It recommends to mask parts not to be lacquered, to protect the surrounding against the spray mist.

The aerosol can should have room temperature.

Temperature should range between +10°C and +25°C, max. air humidity 60 %.

Store in a dry place. Protect from direct sunlight and other sources of heat. Use only during dry weather, in places protected from the wind, and in well-ventilated rooms. Follow the warning texts on the labels!

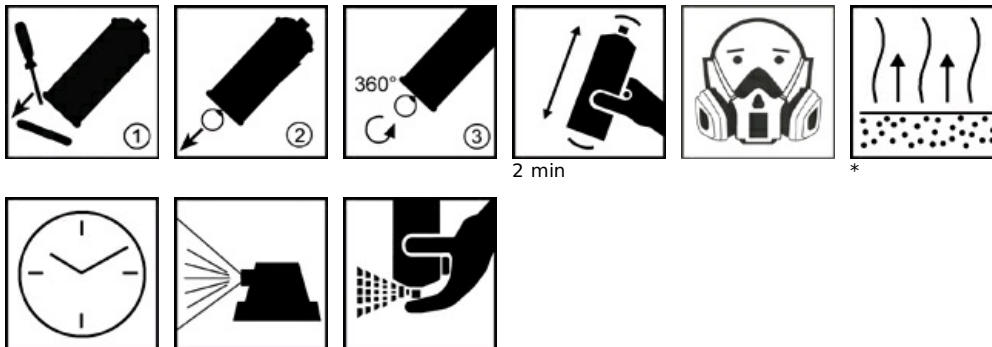

\*Pay attention to manufacturer's instructions/ Angaben des Lackherstellers beachten

### Overview paint manufacturer

Gebinde	Inhalt	Befüllmenge	Art.Nr.	Bezeichnung	Empfohlen für	VPE	EAN
400ml	307ml	100ml	230677	TC-1	<b>Cromax</b> Centari HS 5035, <b>Standox</b> VOC Autolack, <b>Standofleet</b> 2K HS Decklack, <b>Nexa Autocolor</b> 2K Decklack HS+ Serie P471 (bleifrei) <b>Mason</b> CT 2K Topcoat S2000	6	4 048500 230677
400ml	245ml	100ml	249457	TC-2	<b>Spies Hecker</b> Permasolid HS 270/HS 275 <b>Permafleet</b> HS 2K Decklack Serie 670 +Serie 675, <b>Mason</b> CT 2K Topcoat S80	6	4 048500 249457
400ml	300ml	100ml	249471	TC-4	<b>Glasurit</b> Reihe 22 und Reihe 68 <b>PPG</b> GRS Deltron UHS Progress Reihe D60XX <b>Dupont</b> Imron Elite 3.5 VOC PU Topcoat <b>Selemix</b> 2K PUR-Direct Decklack (7-530, 7-536)	6	4 048500 249471
400ml	300ml	80ml	249464	TC-5	<b>Lesonal</b> Top Coat HS 420, <b>Sikkens</b> Autocryl, <b>Mipa</b> OC 2K-PUR-Autolack HS, <b>Valspar</b> MI 2K Acryllack 2:1, <b>De Beer</b> 2K Decklack Serie 3000	6	4 048500 249464

### Disclaimer of liability

This application-technological information is given to the best of our knowledge. The notes mentioned herein are, however, non-binding and do not exempt you from own tests to see whether the products supplied by us are suitable for your special application. The use and processing is beyond our control and therefore exclusively in the responsibility of the user. MOTIP DUPLI is let off the liability, unless the liability-based incident is caused by a fault incurred to MOTIP DUPLI.

For any further technical questions call our hotline +49 (0) 62 66 75-266 from Monday to Thursday from 9 h a.m. to 3 h p.m. or on Friday until 12 h p.m.

As of May 03, 2018

This release replaces all eventually earlier issued versions.

Print date: 17.06.2019

MOTIP DUPLI GmbH | Kurt-Vogelsang-Straße 6 | 74855 Haßmersheim | [info@de.motipdupli.com](mailto:info@de.motipdupli.com)

